

# INSTALLATION INSTRUCTIONS

For CaféCountertops' Solid Wood Countertops with Oil Finish



## PLEASE READ ALL INSTRUCTIONS CAREFULLY PRIOR TO INSTALLATION.

Solid wood countertops are a form of wood furniture, and must be handled with care. Warping, cracking etc. are almost always a result of improper handling, installation or care. This is so often true that our warranty places the burden of proof on you to prove otherwise in the event of a product issue. Products which have been installed are considered to have been accepted, and in no case does warranty extend to cover dismantling, re-installation or utilities trades. Wood is a natural material. Variations in color and appearance are a normal part of wood's natural beauty and do not constitute a defect.

### SUPPORT



FOR A SPAN OVER 10", ADD A SUPPORT BRACKET

**Wood tops require sturdy support.**  
10" max unsupported overhang.  
36" max span between supports  
Additional supports may be needed.

### CONDITION THE SITE



Constantly maintain 65-78°F/18-20°C temperature and 50-60% humidity.

### ACCLIMATIZE

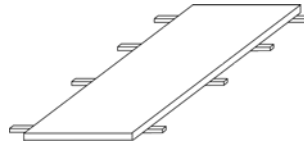

Place the worktop in the room where it will be installed, flat, on spacers for air circulation, for min. 24 hours (longer in dry climates or in winter) prior to installation.

### CHECK FLATNESS



Warping is a natural (and fixable) reaction to changing humidity. Never force a top into flatness. Turn the worktop upside-down on spacers and wait until the top naturally self-corrects.

### PLAN FOR EXPANSION



Wood worktops expand and contract front-to-back (across the grain). Never install fasteners in 'fixed' positions, or the worktop will crack. Allow expansion as shown above.

### CONNECTION

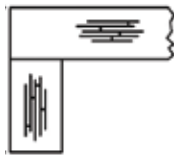

Adjoining worktops must be able to expand and contract independently.

### JOINTS

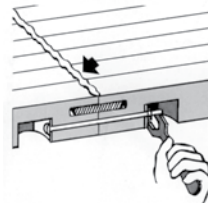

CaféCountertops are custom-built to order with field joints typically factory-prepared for connecting bolts. Bolts should be snug but not over-tight. Fill gap with Silicone.

### FIT

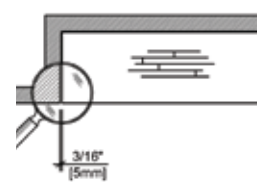

Wood worktops can be scribed or cut to fit as needed. Sand edges which will be exposed to 180-grit. Seal ALL cut edges with Luxury Oil. Allow 3/16" gap at walls for expansion.

### CUTOUTS

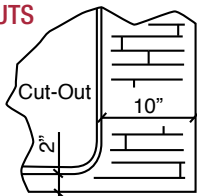

Cutouts located less than 10 inches from worktop end may cause cracking and will void product warranty. Seal all cut edges and inside faucet holes with Luxury Oil.

### SEALANT



Use top-quality Silicone at sinks, joints, gaps at walls, etc. Never use construction adhesive with wood tops. We do not recommend using Silicone in lieu of install fasteners.

### ATTACHMENT IMPORTANT!

Drill oversize or slotted holes in cabinet rails/corner-blocks, to allow fasteners to travel as top expands. Pilot-drill the worktop. Attach worktop with screws and large washers. Slotted brackets (Hafele 260.26.700) may be needed for attachment to wall cleats or table frames.

If cabinets have solid tops, use spacers or make large cutouts for air circulation to underside of worktop.

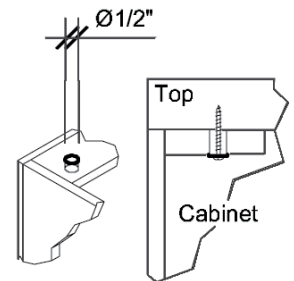

### THERMAL BARRIER

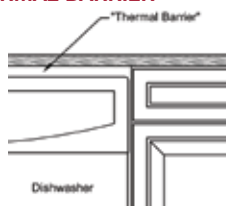

Peel-and-stick micropermeable Thermal Barrier is required at dishwashers and most u/c appliances. Thermal Strip protects cooktop cutout edges.

### CLEAN & PROTECT



Wipe with a dry or slightly moist rag. See Care Instructions for more detail. Wood can scratch and dent even with a cardboard cover. It's safest to prevent any contact whatsoever until construction is complete.

### COMMON PROBLEMS AND SOLUTIONS:

- Iroko tops are golden when new but darken to brown over time.
- Scratches can be spot-repaired. See CaféCountertops' Care Instructions.
- Warping: see "Check Flatness" above. More supports may be necessary.
- End-splits, or "checks", are hairline cracks at worktop ends, a natural weakness in the lumber which commonly opens and closes with seasonal climate change. These are natural and not a manufacturer's defect. Generally harmless, and may close naturally in warm weather, or can be filled with wood filler if desired.
- Larger cracks are caused by improper acclimatizing, improper cutout locations, or from lack of oil. Sand the top in a hidden place to create wood dust, blend this dust with super glue, and fill. Scrape flush before glue sets.
- Refinishing: If modifications, repairs or a sticky surface make refinishing necessary, sand the entire surface to 150 grit and then oil, wait 20 minutes, oil again, and then wipe and buff per Care instructions.